



BETTER. FASTER. CHEAPER

TurnKey Recovery

Managed Direct Repair Program

INVITATION FOR BID (IFB)

<u>IFB Number</u>	<u>Scope Description</u>	<u>Closing Date</u>	<u>Closing Time</u>
GC2022106657-259001-11300	Roof replacement	05/19/2023	4:30 PM CST

Insured Property Owner: Charlotte County BOCC

Property Location Name: Fleet Maintenance

Address Line 1: 18000 Paulson Drive

Address Line 2: -

City: Port Charlotte

State: FL

Zip Code: 33954

DESCRIPTION: Furnish all required labor, materials, and equipment necessary to provide Scope-of-Work at the above-described location. Work is being authorized under the elected FMIT TurnKey Recovery ProgramSM administered by Synergy NDS, Inc. (SynergyNDS) on behalf of the Insured Property Owner, a Member of the Florida Municipal Insurance Trust (FMIT).

SUBMITTAL INSTRUCTIONS: In support of Procurement Guidelines, the IFB Packet includes specifications and terms & conditions associated with the above referenced project information.

- Bids shall be received no later than the Closing Date & Time indicated above. Bids received after above deadline or that are not submitted in accordance to Submittal Instructions may be rejected without further explanation or contractor notification.
- Bid shall be completed and submitted via DocuSign by filling out the **Contractor Submittal Form** (see Page 5 of this IFB Packet). Contractor may attach additional supporting documents that may or may not be used in the overall scoring of the IFB Contractor Submittal. Attachments do not change &/or modify any of the IFB Terms & Conditions as outlined in the following pages (Pages 1-10).
- Contractor IFB Form Submittal **MUST INCLUDE** all applicable Sales Tax or any other Local, State &/or Federally mandated fee(s) within the aggregated Lump Sum Proposal. Do not breakout separately.
- Contractor is responsible to validate all Quantities and Units of Measurements specific to the following scope items &/or products. The information and descriptions provided in the IFB are intended for general guidance purposes only. Contractor may not change or alter any material &/or specifications identified in the IFB for submission purposes without prior written/email notification to: bids@synergynnds.com.
- Contractor has the sole responsibility to ensure that all services and material for BID Submittal (whether stated correctly in the IFB or not) satisfactorily meet all required Codes & Standards, OSHA Guidelines and The Americans with Disabilities Act (ADA).
- Contractor should also consider the approach (if necessary) in which to stock/store material at the jobsite in a safe and secure manner. SynergyNDS will not be responsible for lost or stolen material, supplies or equipment stocked at the jobsite.
- Bid award will be made based on best overall LUMP SUM project value as determined by SynergyNDS in accordance to market valuation, project demands, critical path scheduling – as well as overall Insured Member's WorkForce Participation Goals. Contributing factors, in addition to price, may be considered as necessary to help determine bid award based on any additional criteria set forth by the specific FMIT Insured Member.

8. SynergyNDS reserves the right to modify the IFB Specifications and Terms & Conditions at any time during the bid solicitation process. Timely notice to all bidders will be given via an electronically distributed Addendum.
9. All registered HUB & HUB Zone Contractors, as well as DBEs are encouraged to participate. Additional Contractor Financial Assistance is available to help support daily HUB/DBE Contractor's operations under the terms and condition of a successful contract award.
10. SynergyNDS is an equal opportunity employer and administers all Contracts & Contractor Agreements in accordance to the requirements of 41 CFR §§ 60-1.4(a), 60-300.5(a) and 60-741.5(a).
11. Contractor is strongly encouraged to schedule a Site Visit of the property as necessary to support the IFB Submittal. All scheduled site visits can be requested at bids@synergynds.com.
12. When a mandatory Pre-BID Meeting is identified and scheduled in a specific IFB, Contractor Attendance is a requirement as part of the Solicitation. Contractors who fail to attend the Pre-BID Meeting will not be eligible to participate in the IFB and subsequent submittal process.
13. Contractor can submit all questions &/or concerns specific to the IFB by email to: bids@synergynds.com.

SCOPE-OF-WORK SUMMARY

Refer to **EXHIBIT A** for scope-of-work description.

Yes | No

- | | | | |
|-------------------------------------|--|-------------------------------------|---|
| <input type="checkbox"/> | | <input checked="" type="checkbox"/> | This IFB is part of a publicly advertised solicitation |
| <input type="checkbox"/> | | <input checked="" type="checkbox"/> | This IFB is part of a potential Federally Funded Project. |
| <input checked="" type="checkbox"/> | | <input type="checkbox"/> | This IFB is being distributed externally |
| <input checked="" type="checkbox"/> | | <input type="checkbox"/> | This IFB requires a Contractor Payment or Performance Bond. |
| <input checked="" type="checkbox"/> | | <input type="checkbox"/> | This IFB requires a Pre-BID Meeting |
| <input type="checkbox"/> | | <input checked="" type="checkbox"/> | This IFB supports workforce participation goals. |

**** THE REMAINING PART OF THIS PAGE IS INTENTIONALLY LEFT BLANK ****



IFB EXHIBIT A Scope-of-Work

<u>IFB Number</u>	<u>Scope Description</u>	<u>Closing Date</u>	<u>Closing Time</u>
GC2022106657-259001-11300	Roof replacement	05/19/2023	4:30 PM CST

Insured Property Owner: Charlotte County BOCC

Property Location Name: Fleet Maintenance

Address Line 1: 18000 Paulson Drive

Address Line 2: -

City: Port Charlotte

State: FL

Zip Code: 33954

GENERAL SCOPE DESCRIPTION

Roof replacement of the Fleet Maintenance. The new roof shall consist of a metal, standing seam system.

GENERAL SCOPE-OF-WORK DISCUSSION

Remove the existing roof system and roof insulation.

Install new roof insulation.

The main roof shall consist of a pre-finished roof sheet, rated for UL Class 90, Miami Dade County specification.

a. CFR standing seam roof panel, 3" high seam, 24" wide trapezoidal profile.

b. Metal roof installation shall comply with the specifications as outlined.

The canopy roof shall consist of a pre-finished roof sheet, rated for UL Class 90, Miami Dade County specification.

a. CFR standing seam roof panel, 1.5" high rib, 24" wide profile with stiffening ribs.

b. Canopy roof installation shall comply with the specifications as outlined.

Provide and install eaves, troughs and downspouts. Installation shall comply with the specifications as outlined

Provide thermal blocks between panels.

Fasteners and fastening pattern shall be consistent with the specifications as outlined.

Flashing materials and installation shall comply with the specifications as outlined.

Sealants being utilized shall comply with the specifications as outlined.

For details on the materials and installation requirements, see the attached engineering design specifications and drawings that shall be complied with

This project shall require a payment and performance bond to comply with contract requirements

ADDITIONAL NOTES &/OR REQUIREMENTS

****This project shall require a payment and performance bond to comply with contract requirements****
The contractor shall maintain the job site and ensure the work areas are free from excess debris and materials to ensure there are no exposed hazards to the workers, county staff or general public.

DRAWING & SPECIFICATION DESCRIPTION

Rimkus metal roof replacement specifications and drawings.

Document #1 Roof Plan-SP_S1-S3_1800 Paulson Dr SS

Document #2 NA

ADDITIONAL CONTRACTOR EXPECTATIONS

****This project shall require a payment and performance bond to comply with contract requirements****
The contractor shall maintain the job site and ensure the work areas are free from excess debris and materials to ensure there are no exposed hazards to the workers, county staff or general public.

**Contractor should understand overall expectations as further detailed in the attached TurnKey RecoverySM Contractor Expectation Document in support of accounting for a responsible IFB Submittal.*

GENERAL WORKDAY &/OR JOBSITE CONSIDERATIONS

The contractor shall maintain the job site and ensure the work areas are free from excess debris and materials to ensure there are no exposed hazards to the workers, county staff or general public.

- **Occupant Workday:** Standard (M-F/8-5pm) Wknd/After Hours Other _____
- **Building/Site Occupancy:** Occupied Vacant Partial
- **Site Access:** Open Restricted (Gated/Security)
- **Parking/Laydown Area:** Open/Available Restricted Limited
- **Restroom Facilities:** Fixed/Indoor Portalets Not Available
- **Waste/Debris Containers:** Provided/Onsite Include in BID

Email all IFB Questions to Bids@synergynds.com



BETTER. FASTER. CHEAPER

TurnKey Recovery

Managed Direct Repair Program

IFB – CONTRACTOR SUBMITTAL FORM

<u>IFB Number</u>	<u>Scope Description</u>	<u>Closing Date</u>	<u>Closing Time</u>
GC2022106657-259001-11300	Roof replacement	05/19/2023	4:30 PM CST

Company Name: _____**Address Line 1:** _____**Address Line 2:** _____**City:** _____**State:** _____**Zip Code:** _____**Contractor Certification:** DBE WBE/WOSB HUB SDVOSB/VOSB**CONTRACTOR LUMP SUM PROPOSAL:**

IFB TITLE	PROPOSAL:
	\$

CONTRACTOR NOTES:**MATERIAL DEPOSIT:** Required Requested

\$

I understand that all applicable Sales Tax or any other Local, State &/or Federally mandated fee(s) are to be included within the aggregated Lump Sum Proposal. Do not breakout separately. Contractor may attach additional supporting documents that may or may not be used in the overall scoring of the IFB Contractor Submittal. Attachments do not change &/or modify any of the Terms & Conditions as outlined in the IFB, Scope-of-Work (Exhibit A) and the Turnkey RecoverySM Contractor Expectations.

I, having the legal authorization to represent the “Company” (the undersigned) have read and understood the IFB, its Scope-of-Work and the Turnkey RecoverySM Contractor Expectations in accordance with the Terms & Conditions:

Company Contact Name (Please Print)_____
Company Title (Please Print)_____
Signature_____
Date



BETTER. FASTER. CHEAPER

TurnKey Recovery

Managed Direct Repair Program

TURNKEY RECOVERYSM PROGRAM

Overview & General Contractor Expectations

PROGRAM OVERVIEW

Synergy NDS, Inc. (SynergyNDS) and Florida Municipal Insurance Trust (FMIT) have partnered in support of the critical needs of FMIT's 360+ Public Entities since 2004, representing over \$11 Billion of insured assets. SynergyNDS has the proven capacity and resources necessary to assist Florida Municipalities with disaster planning, preparation, response & recovery.

FMIT Turnkey RecoverySM (Turnkey RecoverySM) is exclusive to Members who insure their fixed real property with FMIT and the insurance coverages offered under their Property Policy. Administered by SynergyNDS, Turnkey RecoverySM supports individual Member's response & recovery directives using a more transparent approach to Project Management throughout the lifecycle of the restoration/repair project. More importantly, Turnkey RecoverySM supports contractors by reducing the "red-tape" and exposure often associated with public entity projects by streamlining the contracting and payment process. All approved Work Authorizations and Invitations for Bid (IFB) Contract Awards with eligible upfront material deposits and progress payments are paid directly by SynergyNDS to applicable contractors within defined terms/conditions. Contractors within Turnkey RecoverySM can be those identified by the Member's own procurement process, as well as those participating in the qualified Managed Vendor Program (MVPSM).

GENERAL CONTRACTOR EXPECTATIONS

Information contained throughout this document supports Turnkey RecoverySM expectations/requirements for a specified Work Authorization, or as necessary for subcontractor to provide a responsible IFB Response submittal. Where any conflicts arise from language outlined in this document in support of a specific Work Authorization or IFB Contract Award (which is inclusive of and incorporated into the Contractor's IFB Response submittal), the General Services Agreement between Contractor and SynergyNDS, or the IFB Contract Award becomes the guiding and controlling form.

1. Contractor shall be responsible for field verification of all conditions, dimensions & quantities associated with work prior to Work Authorization or Contractor IFB Response Submittal. Any Exhibits, Plans, Drawings &/or Other Supporting Documents that may be provided by SynergyNDS to Contractor are for general reference purposes only.
2. Contractor is responsible for identifying and satisfactorily addressing all applicable regulatory requirements, including but not limited to Codes & Standards, HUD/DBE Participation Goals & Guidelines and ADA/FHA Specifications.
3. Contractor shall indicate in writing and submit to SynergyNDS via email distribution to projects@synergynds.com any request or need for additional 3rd Party Assignment as necessary to

further identify required codes & standards, scope specifications or public health safety concerns outside of Contractor's professional competence &/or licenses.

4. Contractor is to obtain their own permits and schedule all applicable inspections. Permits can be obtained by contacting the Building Department or other administering entity. Permit Fees are reimbursable directly from SynergyNDS (in addition to contractor's Lump Sum Proposal) if incurred and submitted with proper documentation.
5. Contractor shall prohibit discrimination against staff &/or available workforce based on their status as protected veterans or individuals with disabilities and prohibit discrimination against all individuals based on their race, color, religion, sex, sexual orientation, gender identity or national origin. Moreover, these regulations require that Contractor and its subcontractors take affirmative action to employ and advance in employment individuals without regard to race, color, religion, sex, sexual orientation, gender identity, national origin, protected veteran status or disability.
6. Contractor is required to be familiar with and follow all OSHA and State of Florida safety requirements, including OSHA form 300 Logs reporting requirements, if applicable.
7. Contractor shall independently implement a site-specific health and safety plan for each project to include hazard communication and related OSHA requirements to protect workers, building occupants, and the public who has access to the work area.
8. Prior to beginning work each day, Contractor is to independently hold jobsite safety meetings that review the work to be performed, the hazards involved with the work, and the acceptable methods for reducing and eliminating such hazards. Contractor shall maintain appropriate meeting records, including a Job Safety Analysis (JSA), or similar, that includes information from the daily jobsite safety meeting, including an attendee list, which shall be maintained by Contractor and available for SynergyNDS review at all times. Contractor shall be solely liable for any and all unsafe acts and/or safety violations associated with their employees.
9. Contractor shall require all employees to be familiar with job-specific hazard mitigation when performing the work, including but not limited to: slip, trip & fall protection, eye and ear protection, hand and foot protection, head protection, fire protection & prevention, confined space protection, employee thermal stress protection, etc.
10. Contractor is responsible for supplying and educating all on-site employees in the proper use of Personal Protective Equipment (PPE), including but not limited to: hard hat(s), safety glasses, face shields, ear plugs, gloves, boots, fall protection (where required), breathing protection (where required), tie off ropes/apparatuses/points (where required), fire extinguishers, first aid kits, etc.
11. Contractor is required to have the appropriate Material Safety Data Sheets (MSDS), and be able to provide to the Industrial Hygienist of record (for the project) for any products used during the performance of their work for which an MSDS is required, including, but not limited to, glues, cleaners, paints, solvents, anti-microbial products, sanitizing agents, etc. The Industrial Hygienist of record retains the right to restrict the use of any of the products selected for use on the project.
12. Contractor shall be responsible under terms of the Agreement for supplying all necessary labor, equipment, tools, materials and travel expense to complete the scope of work unless directed otherwise in the Work Authorization or IFB Contract Award. This includes, but is not limited to: Rental Equipment, Dumpsters, Storage Containers, Jobsite Trailer, General Conditions, Associated

Expenses, Travel Cost and Overhead & Profit which are to be included in the Work Authorization and/or IFB Contract Award.

13. Contractor shall protect all property from damage during the performance of work. This includes, but is not necessarily limited to: wall finishes, floor finishes, windows, electrical systems, mechanical systems, communication systems, life safety systems, security systems, HVAC control systems, plumbing systems, lighting systems, structurally related components, exterior elements, vegetation, property-of-others, etc.
14. Contractor shall be responsible for repair, replacement &/or cleaning of property damaged by employees, as well as any debris, coatings, coverings, overspray, or caulking residue located on any 3rd party property due to actions of Contractor employees. If affected property cannot be successfully cleaned &/or restored to pre-existing condition, SynergyNDS will seek reimbursement from Contractor &/or deduct the appropriate replacement cost from outstanding Invoice Payment (Contract Value).
15. Contractor shall be responsible for securing work area(s) from access by non-authorized building occupants, including all persons not directly part of the restoration, repair and/or rebuild efforts. This includes securing work area(s) as identified in the Work Authorization, IFB Scope-of-Work &/or under Contractor's control.
16. If the Contractor determines that deviations or modifications (change order or supplemental costs) from the initial Work Authorization or IFB Contract Award are required, Contractor shall submit a written request to SynergyNDS for review and approval prior to start of any additional work not otherwise included in initial Work Authorization or IFB Contract Award. The written request will contain, at a minimum:
 - a. Reason for deviation or modification
 - b. Description of deviation or modification
 - c. Project cost addition or subtraction for deviation or modification
 - d. Estimated time required for deviation or modification.
17. Contractor is NOT responsible for any conditions or activities implemented prior to their performance of work and/or arrival to the job site. During the performance of Contractor's work, if pre-existing damage to the building, structure, system failures or other anomalies is found, Contractor has the responsibility to identify, document and report these deficiencies immediately to SynergyNDS by email notification to projects@synergynnds.com. Verbal notification &/or discussion with the onsite Project Manager is encouraged, but not required. Written documentation approved by SynergyNDS must be provided to ensure that pre-existing damages are not the responsibility of the Contractor and to maintain transparency with work performance.
18. Contractor represents that it has adequate and sufficient equipment in good working order and fully trained, licensed personnel capable of safely and efficiently operating such equipment and performing and/or providing (a) restoration &/or repair services work, including, but not limited to labor, supervision, tools, equipment, vehicles, transportation and machinery specific to Work Authorization/IFB Invitation and/or (b) materials, goods, supplies, or other products.
19. Contractor services and scope-of-work will be performed and provided in a good and workmanlike manner with strict adherence to general industry customs and specifications, completed in a safe

manner, and in accordance with all legally required and/or accepted codes and standards. The Services will follow customs and practices of workmanship within Contractor's trade, profession, craft or line of work.

20. Contractor is responsible for submitting all applicable project/contracting documents and progress updates in support of scope-of-work and invoicing to include, but not necessarily limited to any: Architectural Drawings, Work Scope Breakout & Description, Engineering or 3rd Party Reports, Certificates of Insurance, Change Order Requests, Warranty Info/Certificates or any written documentation with SynergyNDS that would otherwise change &/or modify the Work Authorization or IFB Contract.
21. Contractor agrees to provide a workmanship warranty, with a 12-month period of correction from the date that work performed by the Contractor is completed. Contractor will be responsible for remedying any patent or latent defects related to their work performance in accordance with the rules prescribed under Florida Construction Law. For patent defects, SynergyNDS will notify Contractor verbally, or in writing, and Contractor will make a best effort to remedy to the satisfaction of SynergyNDS within 1-5 business days. For latent defects, SynergyNDS will notify Contractor in writing and allow Contractor up to 10 business days to review the defect. SynergyNDS and Contractor will then develop a remediation plan to resolve the latent defect to the satisfaction of SynergyNDS.

PAYMENT: Project is managed by SynergyNDS under the FMIT Turnkey RecoverySM Program. Payments will be made by SynergyNDS directly to the Contractor in accordance with terms & conditions described in the Work Authorization or IFB Contract Award. Qualified contractors may be eligible for an upfront material deposit or progress payments as determined prior to work performance. **Contractor must be registered in the MVP (Managed Vendor Program) whereby required contractor documents must be uploaded to the database. There is annual \$49.95 processing and maintenance fee as part of the initial contractor vetting and background check.**

PAYMENT TERMS: Payments will be made after inspection and approval of work by SynergyNDS, FMIT Member Building Official &/or FMIT Desk Adjuster. Accurate invoices and required project documentation must be submitted to SynergyNDS for project review and/or audit prior to payment. Contractor will provide all applicable product warranty documentation or certification prior to release of final payment. *Material Deposits &/or Advanced Payments require Contractor to complete online registration in the Managed Vendor Program (MVP).

INSURANCE & LICENSING SUMMARY: Before starting work, the Contractor will provide SynergyNDS at minimum, proof of Worker's Compensation and General Liability Insurance. The Contractor must be licensed to do business in the State of Florida, as well as hold whatever specific trade licenses to perform and/or oversee such work in the State of Florida. In some cases, Professional Liability insurance will also be required. SynergyNDS must be named as an additional insured on all liability insurance certificates. Contractor will need to go to www.synergynds.com/MVP and complete the initial registration for the Managed Vendor Program (MVP).

The certificate holder(s) must be noted as:

Synergy NDS, Inc.
1400 Sarno Rd, Melbourne, FL 32935

INSURANCE & LICENSING REQUIREMENTS: Contractor will be required to upload in the MVP Contractor Profile the following information (when applicable) prior to contract award and eligible material deposits.

- a) Workers Compensation Insurance Certificate for all employees engaged in work at the site, in accordance with State or Territorial Worker's Compensation Laws.
- b) General Liability Insurance Certificate with bodily injury and property damage limits at a combined single limit of at least \$500,000 in order to protect the contractor and SynergyNDS against claims for injury or death of one or more persons.
- c) Automobile Liability Certificate on owned and non-owned motor vehicles used on the site(s), or in connection with the sites, for a combined single limit for bodily injury and property damages of not less than \$500,000.00 per occurrence.
- d) Professional Liability Certificate with \$1,000,000 per occurrence (if applicable).

Contractor will not allow any required insurance coverage to lapse, and will provide SynergyNDS with updated Certificates of Insurance, as necessary. All policies must provide at least thirty (30) days' notice of cancellation will be given to SynergyNDS. All Contractor employees &/or subcontractors are bound by the Insurance Requirement. **Contractor is the sole responsible party for all its Employee &/or Subcontractor infractions, accidents, damages, and all general and professional liability concerns that occur, whether directly or indirectly, as related to Work performed by Contractor or subcontractors under the control of Contractor.**

CONTRACT IMPLEMENTATION: Work Authorization or IFB Contract Award will be initiated upon review and comparative analysis of all bids &/or proposals received by SynergyNDS, and in some cases the FMIT Member, in accordance with a defined Procurement Process. Notification of Intent-to-Contract with Contractor will be engaged upon written notification by SynergyNDS and contractor signed/returned General Services Agreement Form. Contract-in-Full will be awarded upon receipt by SynergyNDS of all required contracting documentation, including but not limited to:

- a) Performance Bond &/or Payment Bond (when required)
- b) Certificate of General Liability Insurance
- c) Certificate of Auto Insurance
- d) Certificate of Worker's Compensation or Letter of Exemption
- e) Contractor's W-9
- f) State License Documentation

Further description of insurance requirements is listed in the General Services Agreement. No material deposits &/or payments will be made to Contractor until all required documentation has been received.

\\HOUDSF01\ALL OPEN JOBS\CAT (AEC SERVICES)\OPEN\JOBS\100189039\DESIGN\CAD\3 - ISSUED FOR PERMITTING\ROOF PLAN.SP_S1-S3_1800 PAULSON DR.DWG

1. REFERENCES

- 1.1. THE LATEST EDITION OF ALL LISTED REFERENCES SHALL APPLY:
 - 1.1.1. 2020 FLORIDA BUILDING CODE, EXISTING BUILDING.
 - 1.1.2. ASTM E108 TEST METHODS FOR FIRE TESTS OF ROOF COVERINGS - CLASS A.
 - 1.1.3. ASTM E1592 TEST METHOD FOR WIND UPLIFT PERFORMANCE OF SHEET METAL ROOFING SYSTEMS.
 - 1.1.4. ASTM E1646 TEST METHOD FOR WATER PENETRATION OF EXTERIOR ROOF SYSTEMS.
 - 1.1.5. ASTM E1680 TEST METHOD FOR RATE OF AIR LEAKAGE THROUGH EXTERIOR ROOF SYSTEMS.
 - 1.1.6. ASTM E2140 TEST METHOD FOR WATER PENETRATION OF METAL ROOF PANEL SYSTEMS BY STATIC WATER HEAD
 - 1.1.7. US ARMY CORPS OF ENGINEERS - APPROVED PER CECS 07416 TEST SPECIFICATION
 - 1.1.8. FM4471 CLASS 1 APPROVAL
 - 1.1.9. UL 580 CLASS 90 APPROVAL (CONST. NO'S 552, 552A, 552B, 590)

2. SUBMITTALS

- 2.1. SAMPLES:
 - 2.1.1. UPON AWARD OF THE CONTRACT, CONTRACTOR SHALL SUBMIT SAMPLES OF MATERIALS, WITH THEIR RESPECTIVE FINISHES AND COLOURS FOR REVIEW BY THE CONSULTANT, PRIOR TO FABRICATION. SAMPLES SHALL FULLY REPRESENT THE PHYSICAL AND CHEMICAL PROPERTIES OF THE MATERIALS TO BE SUPPLIED.
- 2.2. MANUFACTURER'S TECHNICAL DATA:
 - 2.2.1. UPON AWARD OF THE CONTRACT, CONTRACTOR SHALL SUBMIT ALL TECHNICAL DATA FROM THE MATERIAL MANUFACTURER.
- 2.3. STRUCTURAL DESIGN LOAD CALCULATIONS:
 - 2.3.1. UPON REQUEST, SUBMIT FOR REVIEW ALL STRUCTURAL DESIGN CALCULATIONS, CERTIFIED BY A PROFESSIONAL ENGINEER LICENSED TO PRACTICE, UPON AWARD OF THE CONTRACT AND PRIOR TO COMMENCING WORK.
- 2.4. SHOP DRAWINGS:
 - 2.4.1. UPON AWARD OF THE CONTRACT AND PRIOR TO COMMENCING WORK, SUBMIT SHOP DRAWINGS, CERTIFIED BY A PROFESSIONAL ENGINEER LICENSED TO PRACTICE, DETAILING ALL COMPONENT MEMBERS AND METHOD OF ATTACHMENT.
 - 2.4.2. SHOP DRAWINGS TO DETAIL ALL COMPONENT MEMBERS AND METHOD OF ATTACHMENT OF THE METAL ROOFING SYSTEM, INCLUDING BUT NOT LIMITED TO: CLADDING STRUCTURAL SUPPORTS, CLADDING PROFILE, TRIM, FLASHINGS AND CLOSURES, METHOD OF SEALING, METHOD OF ANCHORAGE, TYPE OF FASTENERS AND SPACING, TYPE OF MATERIAL, THICKNESS AND FINISHES.
 - 2.4.3. SHOP DRAWINGS TO DETAIL ADDITIONAL PURLINS REQUIRED TO MEET WIND UPLIFT REQUIREMENTS.
- 2.5. PROVIDE INITIAL SCHEDULE WITHIN FIVE (5) WORKING DAYS AFTER CONTRACT AWARD, SHOWING ANTICIPATED PROGRESS STAGES AND FINAL COMPLETION OF WORK. WORK SHALL NOT COMMENCE BEFORE WORK SCHEDULE IS PROVIDED.
- 2.6. SAMPLE COPY OF MANUFACTURER'S WARRANTY.
- 2.7. SAMPLE COPY OF CONTRACTOR'S WARRANTY.
- 2.8. CERTIFICATIONS BY MANUFACTURER OF ROOFING MATERIALS THAT ALL MATERIALS SUPPLIED COMPLY WITH ALL REQUIREMENTS OF THE IDENTIFIED ASTM AND OTHER INDUSTRY STANDARDS OR PRACTICES.
- 2.9. CERTIFICATION FROM THE CONTRACTOR AND ENGINEER THAT THE SYSTEM SPECIFIED MEETS ALL IDENTIFIED CODE AND INSURANCE REQUIREMENTS AS REQUIRED.

3. REGULATORY REQUIREMENTS

- 3.1. CONFORM TO APPLICABLE LOCAL CODE FOR ROOF ASSEMBLY FIRE HAZARD REQUIREMENTS.
- 3.2. UL: CLASS B FIRE HAZARD CLASSIFICATION
- 3.3. FM: ROOF ASSEMBLY CLASSIFICATION, OF CLASS 1 CONSTRUCTION, WIND UPLIFT REQUIREMENT OF I-90, IN ACCORDANCE WITH FM CONSTRUCTION BULLETIN 128.

4. WARRANTY

- 4.1. SUBMIT A WRITTEN WARRANTY FOR THE METAL ROOFING INSTALLATION SPECIFIED IN THIS SECTION COVERING A PERIOD OF TWO (2) YEARS, INCLUDING MATERIALS AND INSTALLATION, AT NO COST TO THE OWNER.
- 4.2. THE CONTRACTOR SHALL WARRANT THAT THE ROOFING INSTALLATION WILL BE FREE FROM DEFECTS RELATED TO WORKMANSHIP OR MATERIALS DEFICIENCIES, INCLUDING BUT NOT LIMITED TO WATER PENETRATION, MATERIAL DEFORMATION AND FADING OF FINISH.
- 4.3. ANY REPAIR REQUIRED UNDER THE WARRANTY WILL BE CARRIED OUT IN ACCORDANCE WITH THE RECOMMENDATIONS OF THE CONSULTANT.
- 4.4. CONTRACTOR SHALL PROVIDE A MANUFACTURER'S WRITTEN WARRANTY: FURNISH PANEL MANUFACTURER'S WRITTEN WARRANTY COVERING FAILURE OF FACTORY-APPLIED EXTERIOR FINISH WITHIN THE WARRANTY PERIOD. WARRANTY PERIOD FOR THE FINISH SHALL BE TWENTY-FIVE (25) YEARS AFTER THE DATE OF SUBSTANTIAL COMPLETION.

5. MATERIALS

- 5.1. MAIN ROOF SYSTEM: PRE-FINISHED ROOF SHEET, EXPOSED TO EXTERIOR, RATED FOR FOR UL CLASS 90, MIAMI-DADE COUNTY AND FACTORY MUTUAL UPLIFT APPROVAL, 'CFR STANDING SEAM ROOF PANELS' BY NUCOR BUILDINGS GROUP OR APPROVED EQUAL.
- 5.2. CANOPY ROOF SYSTEM: PRE-FINISHED ROOF SHEET, EXPOSED TO EXTERIOR, RATED FOR FOR UL 580 CLASS 90, AND MIAMI-DADE COUNTY APPROVAL, 'R-PANEL ROOF PANELS' BY NUCOR BUILDINGS GROUP OR APPROVED EQUAL.
 - 5.2.1. FRAMING: MINIMUM 14 GAUGE STEEL PURLINS SPACED AT 2'-6" O.C. ALONG 20'-0" WIDE EDGE ZONES ONLY, AS SHOWN ON DRAWING S3.
 - 5.2.2. PANEL PROFILES:
 - 5.2.2.1. MAIN ROOF: CFR STANDING SEAM ROOF PANEL, 3" HIGH SEAM, 24" WIDE TRAPEZOIDAL PROFILE
 - 5.2.2.2. CANOPY ROOF: R-PANEL ROOF PANEL, 1.5" HIGH RIB, 24" WIDE PROFILE w/ STIFFENING RIBS
 - 5.2.3. PANEL FINISH: Z275 GALVANIZED (ZINC COATED) SHEET STEEL CONFORMING TO ASTM A792 SS GRADE 50 WITH MINIMUM CORE THICKNESS SHALL BE 24 GAUGE (0.024"), CLASS 1 STEEL HAVING A YIELD STRENGTH OF 50 KSI.
 - 5.2.4. PANEL CLIPS: BL-12. CLIP BASE IS 0.060" 50 KSI STEEL WITH G90 GALVANIZED COATING. CLIP TAB IS 0.036" 50 KSI STEEL WITH G90 GALVANIZED COATING.
 - 5.2.5. SEAM ATTACHMENT: VISE LOCK 360 SEAM NUCOR FOR CFR PANEL CLIP.
 - 5.2.6. THERMAL BLOCKS: PROVIDE THERMAL BLOCKS BETWEEN PANELS AND PURLINS, ADHERED IN PLACE. BLOCKS TO BE PRE-MANUFACTURED EXTRUDED POLYSTYRENE WITH MINIMUM COMPRESSIVE STRENGTH OF 30 PSI.
 - 5.2.7. ROOF FASTENERS:
 - 5.2.7.1. MAIN ROOF - CFR STANDING SEAM ROOF PANELS: CLIPS SECURED TO EACH SUPPORTING MEMBER WITH ONE (1) BL-12 CLIP AND THREE (3) 1/4-14x1-1/2" SDS FASTENER AT EACH STANDING SEAM.
 - 5.2.7.2. CANOPY ROOF - R-PANEL ROOF PANELS: FASTENERS TO PURLINS AS PER MANUFACTURES REQUIREMENTS/GUIDELINES.
- 5.3. INSULATION: POLYPROPYLENE FABRIC FACTORY LAMINATED TO A 6" THICK BLANKET OF LIGHT DENSITY FIBROUS GLASS; WMP-50 BY LAMTEC CORPORATION FACTORY LAMINATED TO CERTIFIED R METAL BUILDING INSULATION BY OWENS CORNING. ROLL WIDTH TO BE 24".
 - 5.3.1. ANYWHERE EXISTING INSULATION IS REMOVED, ADD NEW VINYL FACED INSULATION BLANKET WITH AN R-VALUE EQUAL TO OR BETTER THAN WHAT IS REMOVED. SEAL ALL SEAMS TO BE AIR TIGHT.
- 5.4. CONCEALED FRAMING: SUBGIRTS, SPACERS, CLIPS, CLOSURES, BRACKETS AND SUPPORTS TO CONFORM TO ASTM A653M, GRADE A, BASE METAL 0.048" MINIMUM CORE THICKNESS, HOT-DIPPED GALVANIZED MINIMUM Z275 AFTER FABRICATION.
- 5.5. METAL FLASHING: FLASHINGS, CLOSURE STRIPS, GALVANIZED STEEL 0.024" CORE NOMINAL THICKNESS, Z275 ZINC COATING DESIGNATION TO ASTM A525M-80, PREFINISHED TO CGSB 93-GP-3M, CLASS F1S OR APPROVED EQUIVALENT. COLOUR TO MATCH ROOF PANEL.
- 5.6. STARTER STRIPS: 0.030" CORE NOMINAL THICKNESS TO MATCH FLASHING AND FASTENED AT 12" O.C.
- 5.7. SEALANTS:
 - 5.7.1. CONCEALED LOCATIONS: TAPE OR COMPOUND, NON-SKINNING, NON-DRYING, BUTYL RUBBER.
 - 5.7.2. EXPOSED METAL TO METAL LOCATIONS: ONE PART, MEDIUM MODULUS, MOISTURE CURING SILICONE. COLOUR TO MATCH SUBSTRATES, BUT TO BE APPROVED BY OWNER PRIOR TO INSTALLATION.
 - 5.7.3. PRIMER: AS RECOMMENDED BY SEALANT MANUFACTURER.
- 5.8. ISOLATION COATING: ALKALI RESISTANT BITUMINOUS PAINT.
- 5.9. FASTENERS FOR METAL TO METAL: A304 STAINLESS STEEL SHEET METAL SCREWS, SELF TAPPING.
- 5.10. EXPOSED FASTENERS FOR METAL CLADDING OR FLASHINGS TO WOOD: MINIMUM 0.1875" DIAMETER WOOD SCREW THREAD, HEX HEAD WITH NYLON COATING, C/W ATTACHED NEOPRENE WASHER.
- 5.11. RIVETS: STAINLESS STEEL WITH PAN HEADS PAINTED AFTER INSTALLATION.
- 5.12. SHEET METAL FLASHINGS AT EAVES (DRIP FLASHING), FASCIAS, WALL FLASHINGS, COUNTER FLASHINGS, PARAPETS, STEP FLASHINGS, AND RAKE EDGES: TO BE FABRICATED FROM 24 GAUGE (0.6MM) CORE NOMINAL THICKNESS ZINC COATED STEEL, HAVING A Z275 ZINC COATING DESIGNATION, TO ASTM A653. HOOK STRIPS AND CLEATS SHALL BE TWO GAUGES HEAVIER THAN THE TYPE OF FLASHING MATERIAL BEING EMPLOYED. HOOK STRIP MATERIAL TO BE COMPATIBLE WITH MATERIAL BEING SECURED.
- 5.13. EAVES-TROUGH AND DOWNPIPES: TO BE FABRICATED FROM 24 GAUGE CORE NOMINAL THICKNESS ZINC COATED STEEL, HAVING A Z275 ZINC COATING DESIGNATION, TO ASTM A653.
 - 5.13.1. NEW EAVES-TROUGHS TO BE CUSTOM FABRICATED TO MATCH CONSTRUCTION AND DIMENSION OF TROUGH ON ADJACENT ROOF, MECHANICALLY SECURED TO FASCIA AT MINIMUM 16" O.C.
 - 5.13.2. DOWNPIPE SHALL BE MINIMUM 4" X 4" LOCATED AND SECURED AT ONE (1) PER COLUMN.
 - 5.13.2.1. INCLUDE A MINIMUM 4" KICK OUT AT BASE OF COLUMN.
 - 5.13.3. SECURE DOWNPIPES TO EXISTING EXTERIOR WALL WITH DOUBLE FOLDED 24 GAUGE EVERY 6' VERTICALLY AND WITH A MINIMUM OF TWO STRAPS PER DOWN PIPE.
- 5.14. DISSIMILAR MATERIALS:
 - 5.14.1. PROTECT MATERIAL FROM ELECTROLYTIC ACTION WHEN DISSIMILAR METALS ARE IN CONTACT WITH ONE ANOTHER.
 - 5.14.2. PAINT THE MATING SURFACES OF ALUMINUM AND GALVANIZED STEEL WITH BITUMINOUS OR ZINC CHROMATE PRIMERS. TAPING OR GASKETING WITH NON-ABSORPTIVE MATERIALS OR SEALANTS IS ALSO ACCEPTABLE.

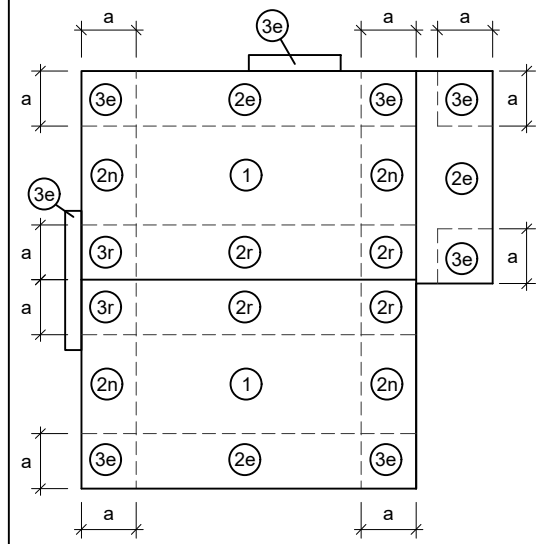

WIND UPLIFT PRESSURES BY ZONE

DESIGN WIND VELOCITY (ULT) 145 MPH

ZONES 1 & 2e	77 PSF
ZONES 2n, 2r & 3e	122 PSF
ZONE 3r	144 PSF

a = 20'-0"

Craig Williams
 Digitally signed by: Craig Williams
 DN: CN = Craig Williams C = US O = North Carolina
 Date: 2023.04.28 10:01:58 - 05'00'

NOTES:

SEAL:

NO.	ISSUED FOR:	DATE (Y-M-D):
1.	ISSUED FOR REVIEW	2023-04-20
2.	REVISION #1	2023-04-24
3.	ISSUED FOR PERMITTING	2023-04-28
4.		
5.		
6.		
7.		

PROJECT:
METAL ROOF REPLACEMENT
18000 PAULSON DR.
PORT CHARLOTTE, FL
ASSET NO.: 259-001

CLIENT:
FLORIDA LEAGUE OF CITIES

TITLE:
SPECIFICATIONS

FOR CLIENT'S SOLE USE PER GOVERNING CONTRACT AND LIMITED TO APPLICABLE PROJECT. NO MODIFICATIONS OR REPRODUCTIONS WITHOUT WRITTEN APPROVAL OF RIMKUS. CONTRACTOR SOLELY RESPONSIBLE FOR VERIFYING ALL DIMENSIONS.

PROJECT NO.:	100189039
DATE (Y-M-D):	2023-04-12
SCALE:	N/A
DESIGNED BY:	M.P.
DRAWN BY:	T.Q.R.S./A.A.S.
CHECKED BY:	M.H./M.P.

DRAWING NO.:
S1
 SHEET NO.: 1 OF 9

LIST OF DRAWINGS

- S1 - SPECIFICATIONS
- S2 - SPECIFICATIONS
- S3 - ROOF PLAN
- D1 - EAVE DETAIL
- D2 - GABLE END DETAIL
- D3 - RIDGE DETAIL
- D4 - EAVE DETAIL (CANOPY)
- D5 - GABLE END DETAIL (CANOPY)
- D6 - HIGHWALL DETAIL (CANOPY)

\\HOUDSF01\ALL OPEN JOBS\CAT (AEC SERVICES)\OPEN\JOBS\100189039\DESIGN\CAD\3 - ISSUED FOR PERMITTING\ROOF PLAN\SP_1-S1-S3_1800 PAULSON DR.DWG

6. FABRICATION

- 6.1. USE COMPETENT MECHANICS AND WORK ACCURATELY TO DETAILS INDICATED AND AS SPECIFIED HEREIN.
- 6.2. VERIFY ALL DIMENSIONS ON SITE PRIOR TO FABRICATION.
- 6.3. FABRICATE SHEET METAL FLASHINGS TO THE SIZE AND SHAPE INDICATED FOR DRIP FLASHINGS; TERMINATION FLASHINGS, STARTER STRIPS AND ALL OTHER FLASHINGS, CLOSURES AND TRIM AS REQUIRED ACCORDING TO SITE MEASUREMENTS.
- 6.4. FABRICATE DRIP AND SILL FLASHINGS TO PROVIDE A MINIMUM 2% SLOPE OUTWARD. END JOINTS OF ADJACENT LENGTHS OF METAL FLASHING SHALL BE MADE USING AN "S-LOCK" JOINT.
- 6.5. ALL EDGES TO BE HEMMED A MINIMUM 0.5" (13MM) FOR APPEARANCE AND STIFFNESS.
- 6.6. INCORPORATE FOR CONCEALED ANCHORAGE OF FLASHING AND MEANS FOR ADJUSTMENT OF LEVEL DURING INSTALLATION.
- 6.7. END JOINTS WHERE ADJACENT LENGTHS OF METAL FLASHING MEET SHALL BE MADE IN ACCORDANCE WITH JOINTING METHOD SPECIFIED HEREINAFTER. ALL JOINTS TO BE LOCKED OR HEMMED A MINIMUM 0.75" - RAW CUT EDGES ON FINISHED SURFACES WILL NOT BE ACCEPTED.
- 6.8. USE COMPETENT MECHANICS AND WORK ACCURATELY TO DETAILS INDICATED AND AS HEREIN SPECIFIED.
- 6.9. FORM TO PROFILE, FREE OF OIL CANNING WITH 8' MAXIMUM LENGTHS.
- 6.10. INSTALL CONTINUOUS CONCEALED LOCKING STRIPS AT ALL EXTERIOR FACES. INSTALL CLEATS AS REQUIRED TO PROTECT MEMBRANE ROOFS AND FLASHINGS FROM DAMAGE AT LOCK JOINTS AND AS OTHERWISE REQUIRED TO PERMANENTLY HOLD FLASHING IN PLACE.
- 6.11. DAMAGED OR BENT SHEETS SHALL BE REJECTED.

7. ROLL INSULATION

- 7.1. INSULATION SHALL BE INSTALLED ACCORDING TO MANUFACTURER'S INSTRUCTIONS.
- 7.2. INSULATION SHALL BE NEATLY CUT TO FIT AROUND PENETRATIONS, AND PROJECTIONS.
- 7.3. INSULATION SHALL BE IN LENGTHS THAT WILL COVER THE DISTANCE FROM EAVE TO EAVE PLUS AN EXTRA 12" ON EACH END TO OVERHANG EACH SIDE OF BUILDING.
- 7.4. IF MORE THAN ONE ROLL IS USED TO SPAN THE ROOF, A RIDGE PAN SHALL BE PROVIDED.
- 7.5. DO NOT INSTALL MORE INSULATION THAN CAN BE COVERED WITH SHEET METAL ROOFING BY THE END OF THE DAY OR THE ONSET OF INCLEMENT WEATHER.
- 7.6. THE WIDTH OF THE FIRST RUN OF INSULATION SHALL BE 1' WIDER THAN THE WIDTH OF THE ROOFING PANEL. SUCCEEDING RUNS SHALL BE EITHER THE SAME WIDTH OR TWICE THE WIDTH OF ROOF PANELS.
- 7.7. START INSTALLATION OF INSULATION AT AN END WALL OF THE BUILDING, TEMPORARILY SECURE ONE END OF THE INSULATION TO THE EAVE STRUT WITH ADHESIVE OR MECHANICAL FASTENER.
- 7.8. UNROLL THE INSULATION ACROSS THE PURLINS WITH THE VAPOUR RETARDER TOWARDS THE INTERIOR. KEEP TENSION ON THE INSULATION WHILE THE METAL PANELS ARE BEING ATTACHED OVER THE INSULATION. DO NOT OVERSTRETCH THE INSULATION.
- 7.9. FASTEN THE INSULATION AT THE OTHER EAVE WITH ADHESIVE OR MECHANICAL FASTENER.
- 7.10. INSTALL THE NEXT ROLL OF INSULATION AS THE FIRST ROLL, ENSURE THE ROLLS ARE STRETCHED TIGHT, PROPERLY ALIGNED AND CLOSELY BUTTED, AND SEAL THE INSULATION TABS AS FOLLOW:
 - 7.10.1. TWO 3" TABS:
 - 7.10.1.1. FASTEN THE FACING TABS TOGETHER, WHERE TWO ADJOINING PIECES OF INSULATION BUTT TOGETHER, WITH A PLIER STAPLER.
 - 7.10.1.2. FIRST, PULL THE FACING TABS IN BETWEEN THE BLANKETS, AWAY FROM THE INSIDE OF THE BUILDING. STAPLE EVERY 4" AT 0.25" TO 0.5" FROM THE EDGE OF THE TABS.
 - 7.10.1.3. FOLD THE STAPLED TABS OVER TO TUCK THEM BETWEEN THE INSULATION BLANKETS AND STAPLE AGAIN.
- 7.11. ONE 6" TAB:
 - 7.11.1. SPRAY OR BRUSH MOISTURE-PROOF ADHESIVE, AS RECOMMENDED BY THE INSULATION MANUFACTURER, ON THE BACK.
 - 7.11.2. EXTEND THE TAB OVER THE FACING OF THE ADJACENT ROLL OF INSULATION AND PRE FIRMLY WITH A DAMP CLOTH ALONG THE SEAM TO SMOOTH AND REMOVE EXCESS ADHESIVE. ENSURE PROPER BONDING BETWEEN ROLLS OF INSULATION.
- 7.12. COVER ANY RIP OR TEAR WITH MATCHING FACING TAPE TO ENSURE A TIGHT SEAL. DO NOT USE PATCHING TO SEAL TABS.
- 7.13. TRIM EXCESSIVE INSULATION FLUSH AT EAVES AND RAKES TO KEEP WATER OUT OF THE INSULATION.
- 7.14. ENSURE ALL SIDE AND END JOINTS TO FORM A CONTINUOUS AIR/VAPOUR BARRIER.

8. METAL ROOF INSTALLATION

- 8.1. NEW METAL ROOF ASSEMBLY TO BE INSTALLED IN ACCORDANCE TO APPROVED SHOP DRAWINGS.
- 8.2. INSTALLED PERPENDICULAR TO THE STEEL SUPPORTING MEMBERS. SECURED TO EACH SUPPORTING MEMBER WITH ONE (1) BL-12 CLIP AND THREE (3) 1/4-14x1-1/2" SDS FASTENERS AT EACH STANDING SEAM.
- 8.3. INSTALL PREFORMED METAL ROOFING SYSTEM IN ACCORDANCE WITH MANUFACTURER'S WRITTEN INSTRUCTIONS.
- 8.4. ENSURE SEAM COVER IS POSITIVELY LOCKED FOR FULL LENGTH OF ROOF SEAM. FIELD CUT MITRES WHERE APPLICABLE.
- 8.5. PROVIDE NOTCHED AND FORMED CLOSURES, SEALED AGAINST WEATHER PENETRATION, AT CHANGES IN PITCH, AND AT RIDGES AND EAVES, WHERE REQUIRED. SEALANT TO BE APPLIED BETWEEN THE CLOSURE AND ROOF PANEL ON THE HIDDEN SIDE (UP SLOPE SIDE) OF THE CLOSURE.
- 8.6. INSTALL ALL COMPANIONS FLASHING AS SHOWN ON THE SHOP DRAWINGS. USE CONCEALED FASTENERS WHERE POSSIBLE.
- 8.7. EXPOSED OR FACE FASTENING WILL NOT BE PERMITTED EXCEPT AS SHOWN ON APPROVED SHOP DRAWINGS.
- 8.8. LOCK END JOINTS AND SEALED TO PROVIDE WEATHER TIGHT SEAL.
- 8.9. INSTALL WATERPROOFING MEMBRANE AT NEW ROOF TO WALL, UPPER ROOF, AND RAKE END DETAILS PRIOR TO INSTALLATION OF SHEET METAL FLASHINGS.

9. SHEET METAL FLASHING

- 9.1. VERIFY ALL DIMENSIONS FROM ON SITE MEASUREMENTS PRIOR TO FABRICATION.
- 9.2. ALL END JOINTS OF ADJACENT LENGTHS OF METAL FLASHING MUST BE MADE USING CONCEALED FASTENERS AT AN "S-LOCK" JOINT. LAPPED JOINTS WILL NOT BE ACCEPTED.
- 9.3. ALL METAL EDGES SHALL BE HEMMED A MINIMUM 0.5" FOR APPEARANCE AND STIFFNESS. EXPOSED CUT EDGES WILL NOT BE ACCEPTED.
- 9.4. STEP FLASHINGS SHALL BE INSTALLED WITH A 3" HEAD LAP OVER LOWER FLASHING. DO NOT SECURE STEP FLASHING TO WALL.
- 9.5. INSTALL CONTINUOUS CONCEALED LOCKING STRIPS AT ALL EXTERIOR FACES. INSTALL CLEATS AS REQUIRED TO PROTECT MEMBRANE ROOFS AND FLASHINGS FROM DAMAGE AT LOCK JOINTS AND AS OTHERWISE REQUIRED TO PERMANENTLY HOLD FLASHING IN PLACE. REFER TO DETAIL DRAWINGS.
- 9.6. DRIP EDGE FLASHINGS TO BE INSTALLED AT EAVES AND RAKES, TO HAVE A MINIMUM 3" WIDE FLANGE. AT EAVES-TROUGHS, ENSURE DRIP EDGE EXTENDS A MINIMUM OF 1" BELOW TOP EDGE OF THE EAVES-TROUGH AS DETAILED.
- 9.7. THE USE OF A PREFABRICATED DRIP EDGE FLASHING IS NOT PERMITTED.
- 9.8. LAP JOINTS IN METAL FLASHINGS SHALL BE A MINIMUM 2" AND EMBEDDED IN POLYURETHANE SEALANT.

10. EAVESTROUGHS AND DOWNSPOUTS

- 10.1. TO BE FABRICATED AS PER MANUFACTURER'S RECOMMENDATIONS.
- 10.2. NEW EAVES-TROUGH TO BE 5" WIDE AT THE TOP OPEN EDGE. EAVES-TOUGH TO BE COLD FORMED, SEAMLESS TO THE LONGEST LENGTH POSSIBLE. SEALANT TO BE APPLIED WITHIN THE OVERLAPPED SEAMS PRIOR TO SECURING WITH STAINLESS STEEL RIVETS.
- 10.3. PROVIDE EXPANSION JOINTS IF REQUIRED FOR RUNS OF EAVESTROUGH OVER 40 LINEAR FEET IN LENGTH.
- 10.4. SECURE THE NEW EAVES-TROUGH TO THE STRUCTURE TO NEW HEAVY GALVANIZED METAL BRACKETS EVERY 16" O.C. MINIMUM.
- 10.5. AFFIX PRE-FINISHED METAL DOWNPIPES TO THE NEW EAVES-TROUGH AT THE EXISTING LOCATIONS.
- 10.6. INSTALL PRE-FINISHED COVER STEEL PLATE BENT TO SHAPE OF A TOP HAT OVER THE BOTTOM 10' OF EACH DOWNSPOUT.

11. SEALANTS

- 11.1. VERIFY ALL APPLICATION METHODS AND REQUIRED LOCATIONS WITH OWNERS REPRESENTATIVE PRIOR TO COMMENCING SEALANT INSTALLATION.
- 11.2. WHERE EXISTING, REMOVE SEALANT COMPLETELY. IN NO CASE SHALL NEW SEALANT BE APPLIED OVER OLD. IN ADDITION:
- 11.3. REMOVE DUST, OIL, GREASE, OXIDATION, MILL SCALE, COATINGS AND ALL OTHER LOOSE MATERIAL CAREFULLY. GRIND EDGES OF EXISTING JOINTS AS REQUIRED TO REMOVE THE EXISTING SEALANT. ENSURE DEPTH OF JOINT IS SUFFICIENT FOR THE INSTALLATION OF THE BACKER ROD OR BOND BREAKER TAPE. ROUT OUT JOINT AS REQUIRED.
- 11.4. CLEAN DOWN SURFACES TO BE CAULKED WITH CLEAN CELLULOSE SPONGES OR RAGS SOAKED IN SOLVENT RECOMMENDED BY THE SEALANT MANUFACTURER AND WIPE DRY WITH CLEAN CLOTH. ENSURE THAT SOLVENT DOES NOT DAMAGE EXISTING FINISHES.
- 11.5. USE METHOD OF SURFACE PREPARATION SUITABLE FOR SUBSTRATE, AS RECOMMENDED BY SEALANT MANUFACTURER AND THAT DOES NOT DAMAGE EXISTING FINISHES.
- 11.6. PRIME SURFACES AS REQUIRED BY MANUFACTURER.
- 11.7. TOOL ALL JOINTS TO SMOOTH, CONCAVE FINISH, FREE FROM SAGS, WRINKLES OR VARIATIONS.

12. CLEANING

- 12.1. DAILY AS THE WORK PROCEEDS AND ON COMPLETION, REMOVE ALL SURPLUS MATERIALS AND DEBRIS RESULTING FROM THE FOREGOING WORK.
- 12.2. REMOVE ALL STAINS, CAULKING OR OTHER ADHESIVE FROM ALL AFFECTED SURFACES.

NOTES:



1900 S. HARBOR CITY BLVD, SUITE 228
MELBOURNE, FL 32901
EXPERT@RIMKUS.COM
(866) 229-0302

SEAL:

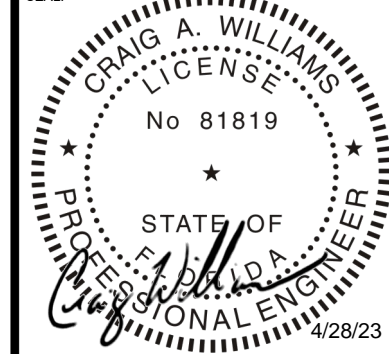

NO.	ISSUED FOR:	DATE (Y-M-D):
1.	ISSUED FOR REVIEW	2023-04-20
2.	REVISION #1	2023-04-24
3.	ISSUED FOR PERMITTING	2023-04-28
4.		
5.		
6.		
7.		

PROJECT:

METAL ROOF REPLACEMENT
18000 PAULSON DR.
PORT CHARLOTTE, FL
ASSET NO.: 259-001

CLIENT:

FLORIDA
LEAGUE OF CITIES

TITLE:

SPECIFICATIONS

FOR CLIENT'S SOLE USE PER GOVERNING CONTRACT AND LIMITED TO APPLICABLE PROJECT. NO MODIFICATIONS OR REPRODUCTIONS WITHOUT WRITTEN APPROVAL OF RIMKUS. CONTRACTOR SOLELY RESPONSIBLE FOR VERIFYING ALL DIMENSIONS.

PROJECT NO.:	100189039
DATE (Y-M-D):	2023-04-12
SCALE:	N/A
DESIGNED BY:	M.P.
DRAWN BY:	T.Q.R.S./A.A.S.
CHECKED BY:	M.H./M.P.

DRAWING NO.:	S2
SHEET NO.:	2 OF 9

\\HOUDFS01ALL_OPEN_JOBS\CAT\AN (AEC SERVICES)\OPEN\JOBS\100189039\DESIGN\CAD\3 - ISSUED FOR PERMITTING\ROOF PLAN-SP_S1-S3_1800 PAULSON DR.DWG

SITE MAP (N.T.S.)

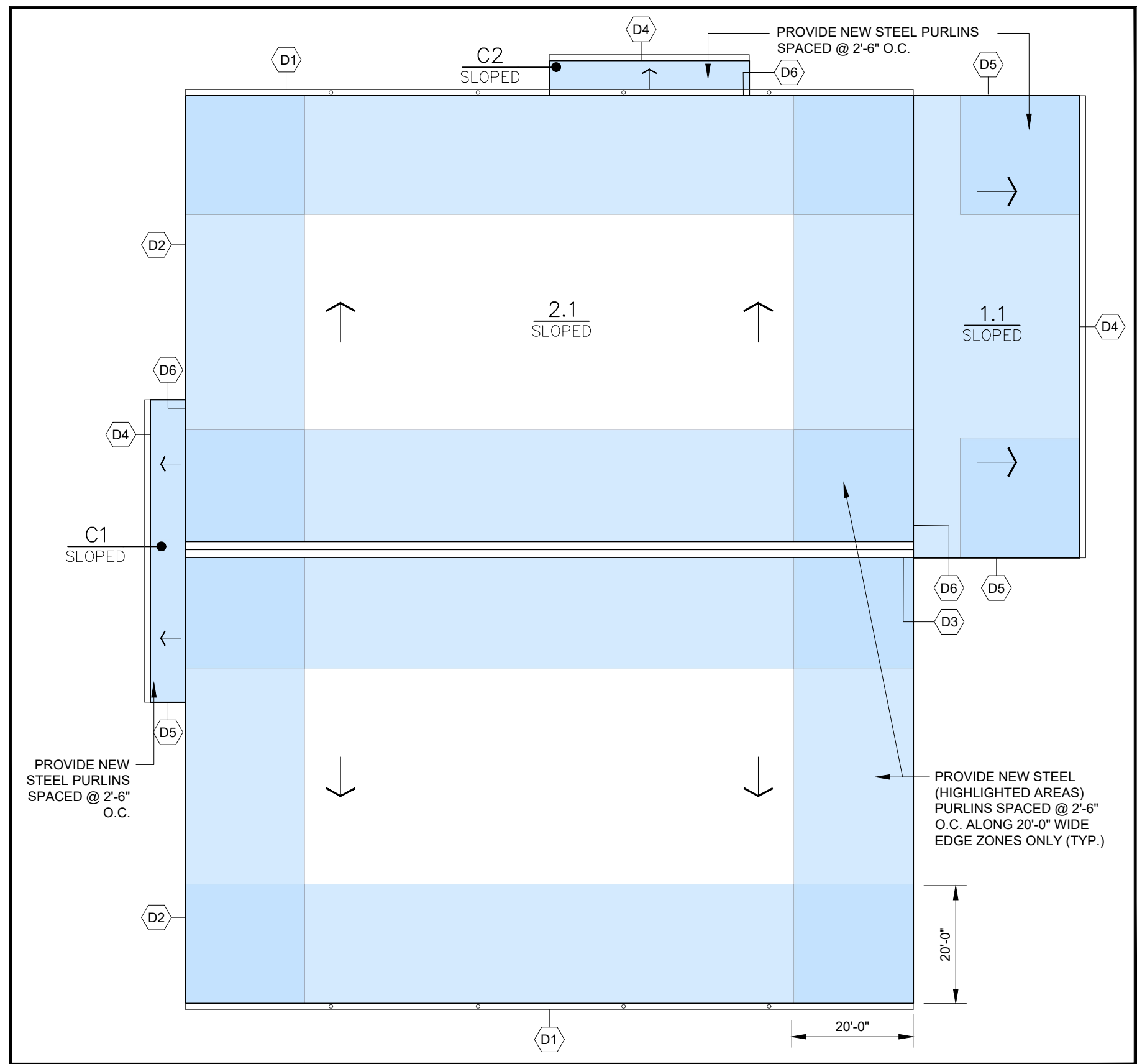
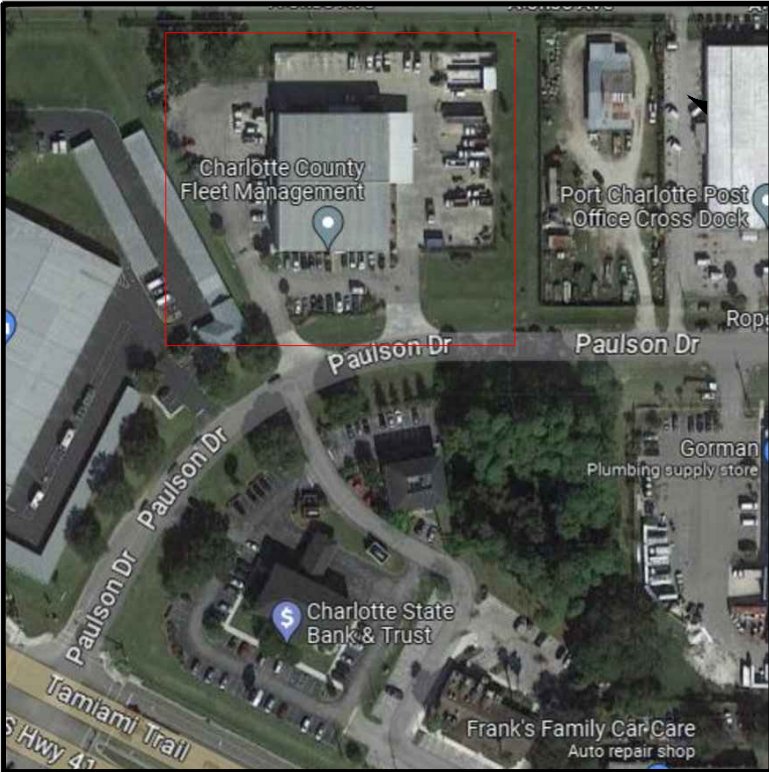

EXISTING ROOF COMPOSITIONS

ROOF AREAS C1 & C2	ROOF AREAS 1.1 & 2.1
METAL PURLIN	METAL PURLIN
METAL ROOF PANELS	INSULATION BLANKET METAL ROOF PANELS

ROOF AREAS

ROOF ID	SQ.FT.
C1	299
C2	198
1.1	2,162
2.1	18,568
TOTAL:	= 21,227

NEW ROOF COMPOSITIONS

ROOF AREA C1 & C2	ROOF AREAS 1.1 & 2.1
EXISTING METAL PURLINS	EXISTING METAL PURLIN
NEW METAL ROOF PANELS	NEW INSULATION BLANKET NEW METAL ROOF PANELS

NOTES:

PROJECT NORTH:

RIMKUS
1900 S. HARBOR CITY BLVD, SUITE 228
MELBOURNE, FL 32901
EXPERT@RIMKUS.COM
(866) 229-0302

SEAL:

NO.	ISSUED FOR:	DATE (Y-M-D):
1.	ISSUED FOR REVIEW	2023-04-20
2.	REVISION #1	2023-04-24
3.	ISSUED FOR PERMITTING	2023-04-28
4.		
5.		
6.		
7.		

PROJECT:
**METAL ROOF REPLACEMENT
1800 PAULSON DR.
PORT CHARLOTTE, FL
ASSET NO.: 259-001**

CLIENT:
**FLORIDA
LEAGUE OF CITIES**

TITLE:
ROOF PLAN

FOR CLIENT'S SOLE USE PER GOVERNING CONTRACT AND LIMITED TO APPLICABLE PROJECT. NO MODIFICATIONS OR REPRODUCTIONS WITHOUT WRITTEN APPROVAL OF RIMKUS. CONTRACTOR SOLELY RESPONSIBLE FOR VERIFYING ALL DIMENSIONS.

PROJECT NO.: 100189039
DATE (Y-M-D): 2023-04-12
SCALE: 1" = 20'
DESIGNED BY: M.P.
DRAWN BY: T.Q.R.S./A.A.S.
CHECKED BY: M.H./M.P.

DRAWING NO.: **S3**
SHEET NO.: 3 OF 9

\\HOU\DFS01\ALL OPEN JOBS\CAT IAN (AEC SERVICES)\OPEN JOBS\100189039\DESIGN\CAD3 - ISSUED FOR PERMITTING\1-GLN036-RR-INSUL-METAL ROOF EAVE GUTTER.DWG

THIS IS A GENERIC ROOFING DETAIL.
 MODIFY AS REQUIRED TO SUIT ACTUAL SITE CONDITIONS.
 ALL SITE CONDITIONS AND MEASUREMENTS TO BE
 CONFIRMED BY CONTRACTOR.
 CONTRACTOR TO SUBMIT SHOP DRAWINGS FOR REVIEW.

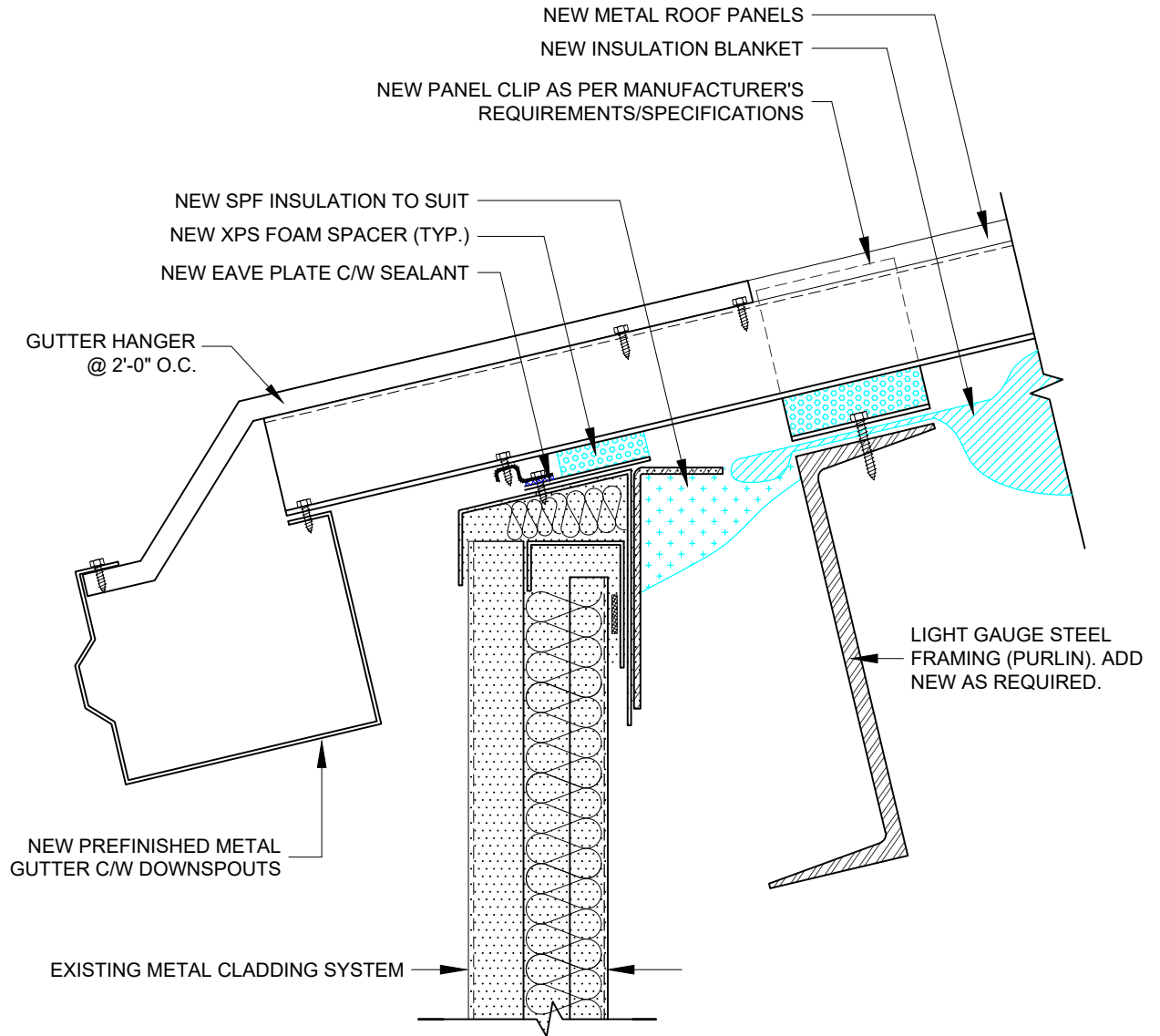

RIMKUS
 1900 S. HARBOR CITY BLVD, SUITE 228
 MELBOURNE, FL 32901
 EXPERT@RIMKUS.COM
 (866) 229-0302

SEAL:

 CRAIG A. WILLIAMS
 LICENSE
 No 81819
 STATE OF FLORIDA
 PROFESSIONAL ENGINEER
 4/28/23

PROJECT: METAL ROOF REPLACEMENT (ASSET NO. 259-001)
 18000 PAULSON DR. PORT CHARLOTTE, FL
 CLIENT: FLORIDA LEAGUE OF CITIES
 SHEET TITLE: EAVE DETAIL w/ GUTTER

FOR CLIENT'S SOLE USE PER GOVERNING CONTRACT AND LIMITED TO APPLICABLE PROJECT. NO MODIFICATIONS OR REPRODUCTIONS WITHOUT WRITTEN APPROVAL OF RIMKUS. CONTRACTOR SOLELY RESPONSIBLE FOR VERIFYING ALL DIMENSIONS.

NO.	ISSUED FOR:	DATE (Y-M-D):
1.	ISSUED FOR REVIEW	2023-04-20
2.	REVISION #1	2023-04-24
3.	ISSUED FOR PERMITTING	2023-04-28
4.		
5.		
6.		
7.		

PROJECT NO.: 100189039
 DESIGNED BY: M.P.
 DRAWN BY: A.A.S.
 CHECKED BY: M.H./M.P.
 SCALE: 3" = 1'-0"

DATE (Y-M-D): 2023-04-17
 DRAWING NO.:
D1
 SHEET NO.: 4 OF 9

GLN036

I:\HOU\DFS01\ALL OPEN JOBS\CAT IAN (AEC SERVICES)\OPEN JOBS\100189039\DESIGN\CAD\3 - ISSUED FOR PERMITTING\D2-GL N036-RR-INSUL_METAL ROOF GABLE END.DWG

THIS IS A GENERIC ROOFING DETAIL.
 MODIFY AS REQUIRED TO SUIT ACTUAL SITE CONDITIONS.
 ALL SITE CONDITIONS AND MEASUREMENTS TO BE
 CONFIRMED BY CONTRACTOR.
 CONTRACTOR TO SUBMIT SHOP DRAWINGS FOR REVIEW.

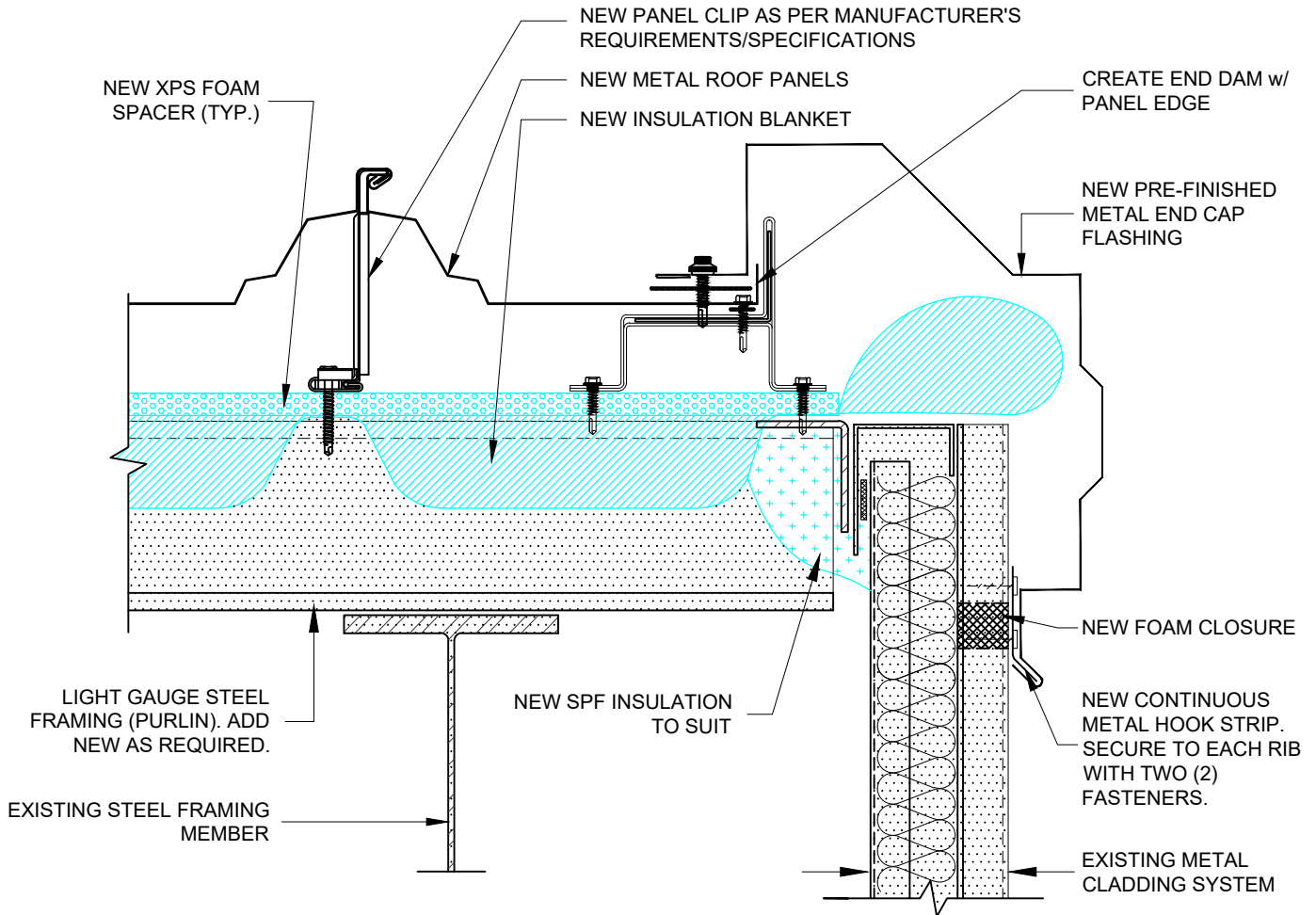

RIMKUS

1900 S. HARBOR CITY BLVD, SUITE 228
 MELBOURNE, FL 32901
 EXPERT@RIMKUS.COM
 (866) 229-0302

SEAL:

PROJECT: METAL ROOF REPLACEMENT (ASSET NO. 259-001)
 18000 PAULSON DR. PORT CHARLOTTE, FL

CLIENT: FLORIDA LEAGUE OF CITIES

SHEET TITLE: GABLE END DETAIL

FOR CLIENT'S SOLE USE PER GOVERNING CONTRACT AND LIMITED TO APPLICABLE PROJECT. NO MODIFICATIONS OR REPRODUCTIONS WITHOUT WRITTEN APPROVAL OF RIMKUS. CONTRACTOR SOLELY RESPONSIBLE FOR VERIFYING ALL DIMENSIONS.

NO.	ISSUED FOR:	DATE (Y-M-D):
1.	ISSUED FOR REVIEW	2023-04-20
2.	REVISION #1	2023-04-24
3.	ISSUED FOR PERMITTING	2023-04-28
4.		
5.		
6.		
7.		

PROJECT NO.: 100189039

DESIGNED BY: M.P.

DRAWN BY: A.A.S.

CHECKED BY: M.H./M.P.

SCALE: 3" = 1'-0"

DATE (Y-M-D): 2023-04-17

DRAWING NO.: **D2**

SHEET NO.: 5 OF 9

GLN036

1\H0UDFS01\ALL OPEN JOBS\CAT IAN (AEC SERVICES)\OPENJOBS\100180039\DESIGN\CAD3 - ISSUED FOR PERMITTING\DS-GLN037-RR-INSUL_METAL ROOF RIDGE.DWG

THIS IS A GENERIC ROOFING DETAIL.
 MODIFY AS REQUIRED TO SUIT ACTUAL SITE CONDITIONS.
 ALL SITE CONDITIONS AND MEASUREMENTS TO BE
 CONFIRMED BY CONTRACTOR.
 CONTRACTOR TO SUBMIT SHOP DRAWINGS FOR REVIEW.

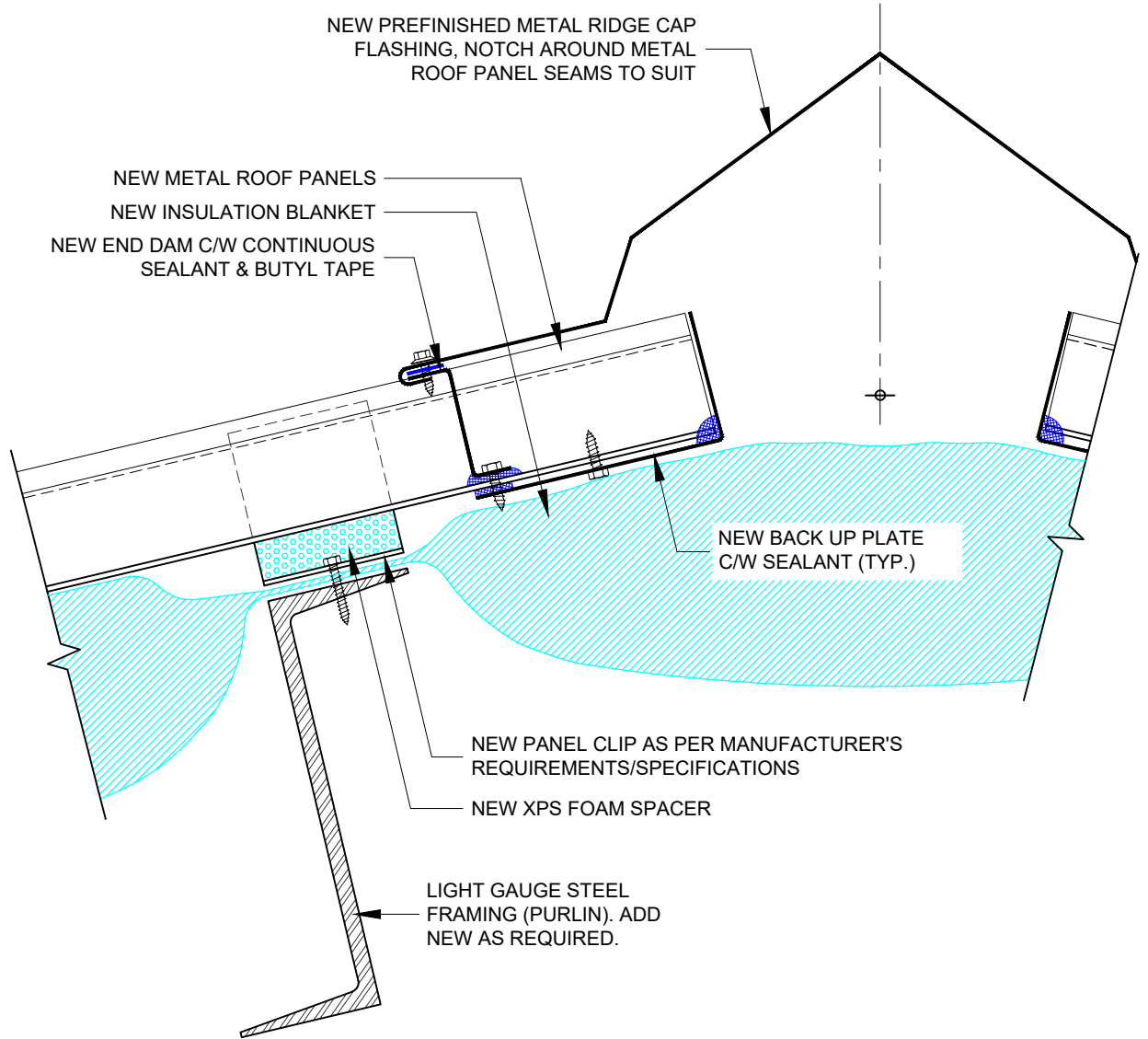

1900 S. HARBOR CITY BLVD, SUITE 228
 MELBOURNE, FL 32901
 EXPERT@RIMKUS.COM
 (866) 229-0302

SEAL:

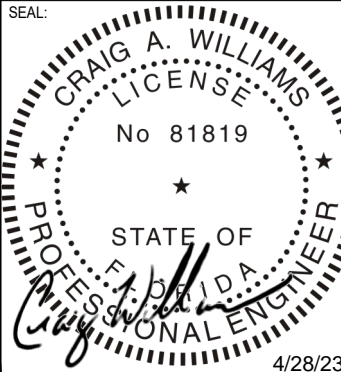

PROJECT: METAL ROOF REPLACEMENT (ASSET NO. 259-001)
 18000 PAULSON DR. PORT CHARLOTTE, FL

CLIENT: FLORIDA LEAGUE OF CITIES

SHEET TITLE: RIDGE DETAIL

FOR CLIENT'S SOLE USE PER GOVERNING CONTRACT AND LIMITED TO APPLICABLE PROJECT. NO MODIFICATIONS OR REPRODUCTIONS WITHOUT WRITTEN APPROVAL OF RIMKUS. CONTRACTOR SOLELY RESPONSIBLE FOR VERIFYING ALL DIMENSIONS.

NO.	ISSUED FOR:	DATE (Y-M-D):
1.	ISSUED FOR REVIEW	2023-04-20
2.	REVISION #1	2023-04-24
3.	ISSUED FOR PERMITTING	2023-04-28
4.		
5.		
6.		
7.		

PROJECT NO.: 100189039
 DESIGNED BY: M.P.
 DRAWN BY: A.A.S.
 CHECKED BY: M.H./M.P.
 SCALE: 3" = 1'-0"

DATE (Y-M-D): 2023-04-17
 DRAWING NO.:
D3
 SHEET NO.: 6 OF 9

GLN037

\\HOU\FS01\ALL_OPEN_JOBS\CAT\IAN (AEC SERVICES)\OPEN\OBS\100189039\DESIGN\CAD\3 - ISSUED FOR PERMITTING\D4-GLN032-RR_METAL ROOF EAVE.DWG

THIS IS A GENERIC ROOFING DETAIL.
 MODIFY AS REQUIRED TO SUIT ACTUAL SITE CONDITIONS.
 ALL SITE CONDITIONS AND MEASUREMENTS TO BE
 CONFIRMED BY CONTRACTOR.
 CONTRACTOR TO SUBMIT SHOP DRAWINGS FOR REVIEW.

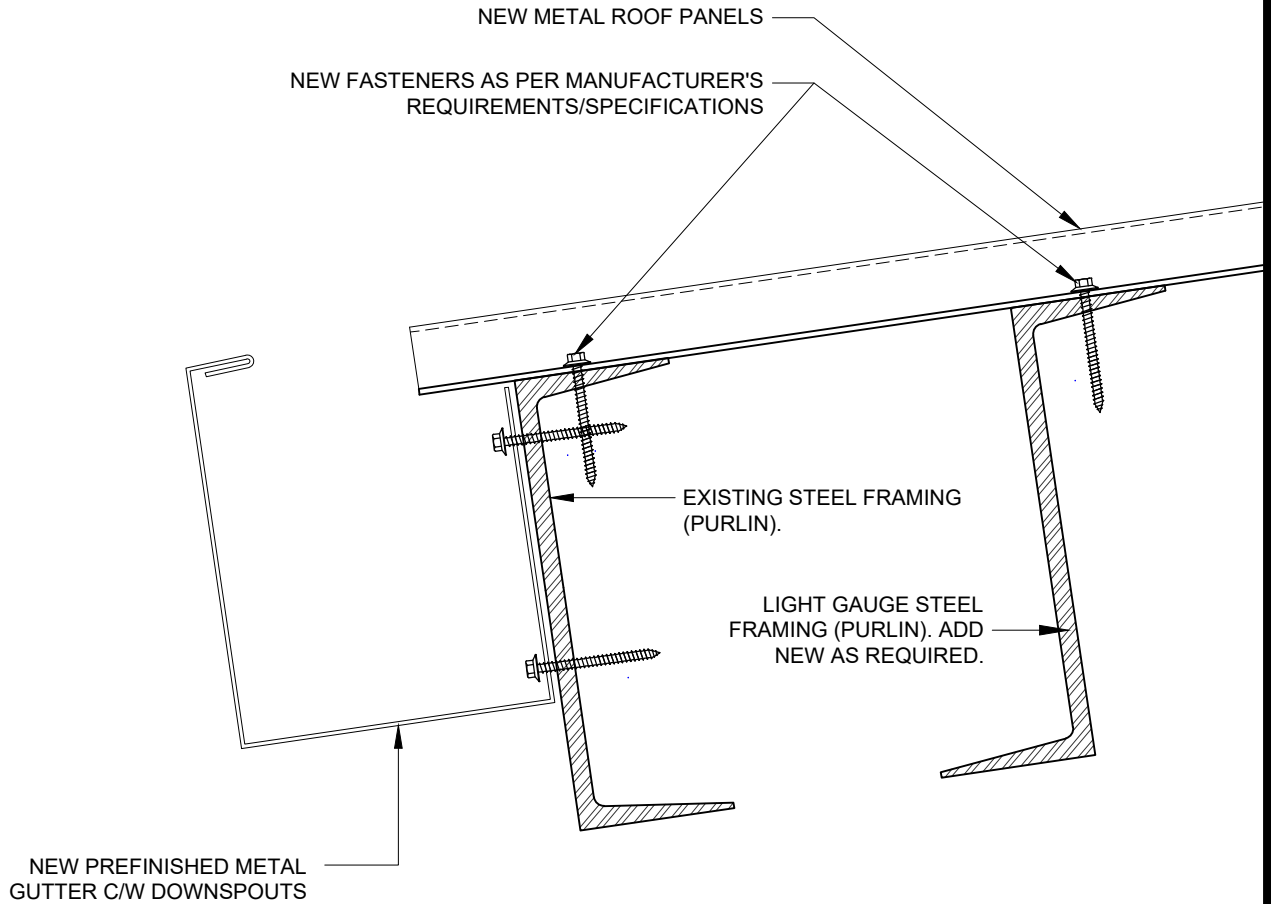

1900 S. HARBOR CITY BLVD, SUITE 228
 MELBOURNE, FL 32901
 EXPERT@RIMKUS.COM
 (866) 229-0302

SEAL:

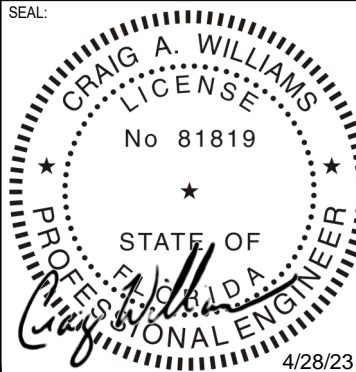

PROJECT: METAL ROOF REPLACEMENT (ASSET NO. 259-001)
 18000 PAULSON DR. PORT CHARLOTTE, FL

CLIENT: FLORIDA LEAGUE OF CITIES

SHEET TITLE: EAVE DETAIL w/ GUTTER (CANOPY ROOFS)

FOR CLIENT'S SOLE USE PER GOVERNING CONTRACT AND LIMITED TO APPLICABLE PROJECT. NO MODIFICATIONS OR REPRODUCTIONS WITHOUT WRITTEN APPROVAL OF RIMKUS. CONTRACTOR SOLELY RESPONSIBLE FOR VERIFYING ALL DIMENSIONS.

NO.	ISSUED FOR:	DATE (Y-M-D):
1.	ISSUED FOR REVIEW	2023-04-20
2.	REVISION #1	2023-04-24
3.	ISSUED FOR PERMITTING	2023-04-28
4.		
5.		
6.		
7.		

PROJECT NO.: 100189039

DESIGNED BY: M.P.

DRAWN BY: A.A.S.

CHECKED BY: M.H./M.P.

SCALE: 3" = 1'-0"

DATE (Y-M-D): 2023-04-17

DRAWING NO.: **D4**

SHEET NO.: 7 OF 9

GLN032

I:\HOUDFS01\ALL OPEN JOBS\CAT\IAN (AEC SERVICES)\OPEN\JOBS\100189039\DESIGN\CAD\3 - ISSUED FOR PERMITTING\05-GLN033-RR_METAL ROOF GABLE END.DWG

THIS IS A GENERIC ROOFING DETAIL.
 MODIFY AS REQUIRED TO SUIT ACTUAL SITE CONDITIONS.
 ALL SITE CONDITIONS AND MEASUREMENTS TO BE
 CONFIRMED BY CONTRACTOR.
 CONTRACTOR TO SUBMIT SHOP DRAWINGS FOR REVIEW.

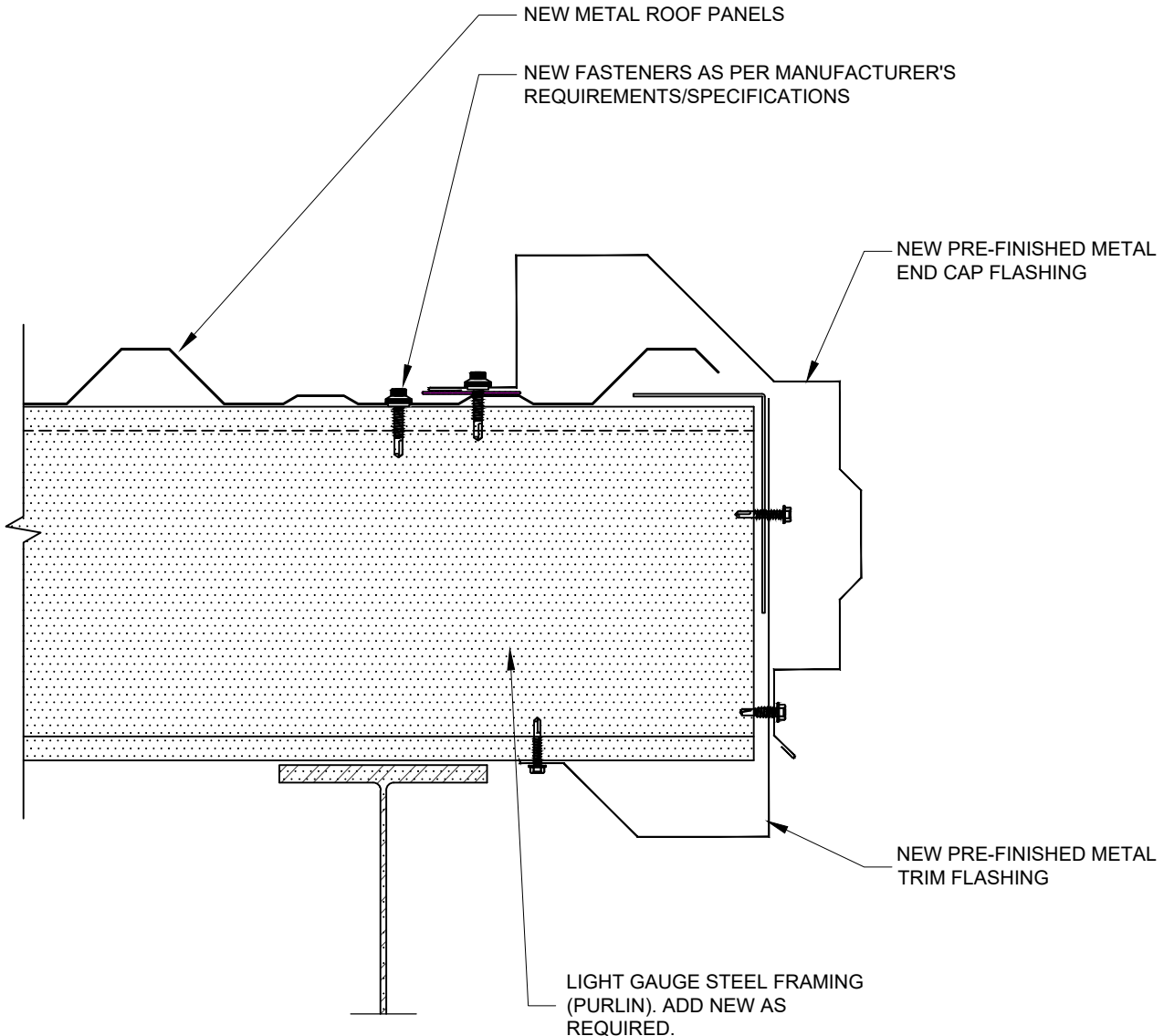

1900 S. HARBOR CITY BLVD, SUITE 228
 MELBOURNE, FL 32901
 EXPERT@RIMKUS.COM
 (866) 229-0302

SEAL:

4/28/23

PROJECT: METAL ROOF REPLACEMENT (ASSET NO. 259-001)
 18000 PAULSON DR. PORT CHARLOTTE, FL

CLIENT: FLORIDA LEAGUE OF CITIES

SHEET TITLE: GABLE END DETAIL (CANOPY ROOFS)

FOR CLIENT'S SOLE USE PER GOVERNING CONTRACT AND LIMITED TO APPLICABLE PROJECT. NO MODIFICATIONS OR REPRODUCTIONS WITHOUT WRITTEN APPROVAL OF RIMKUS. CONTRACTOR SOLELY RESPONSIBLE FOR VERIFYING ALL DIMENSIONS.

NO.	ISSUED FOR:	DATE (Y-M-D):
1.	ISSUED FOR REVIEW	2023-04-20
2.	REVISION #1	2023-04-24
3.	ISSUED FOR PERMITTING	2023-04-28
4.		
5.		
6.		
7.		

PROJECT NO.: 100189039

DESIGNED BY: M.P.

DRAWN BY: A.A.S.

CHECKED BY: M.H./M.P.

SCALE: 3" = 1'-0"

DATE (Y-M-D): 2023-04-17

DRAWING NO.: **D5**

SHEET NO.: 8 OF 9

GLN033

I:\HOU\DF\01\ALL OPEN JOBS\CAT IAN (AEC SERVICES)\OPEN\JOBS\100189039\DESIGN\CAD3 - ISSUED FOR PERMITTING\DWG-GLN040-RR_METAL ROOF HIGHWALL.DWG

THIS IS A GENERIC ROOFING DETAIL.
 MODIFY AS REQUIRED TO SUIT ACTUAL SITE CONDITIONS.
 ALL SITE CONDITIONS AND MEASUREMENTS TO BE
 CONFIRMED BY CONTRACTOR.
 CONTRACTOR TO SUBMIT SHOP DRAWINGS FOR REVIEW.

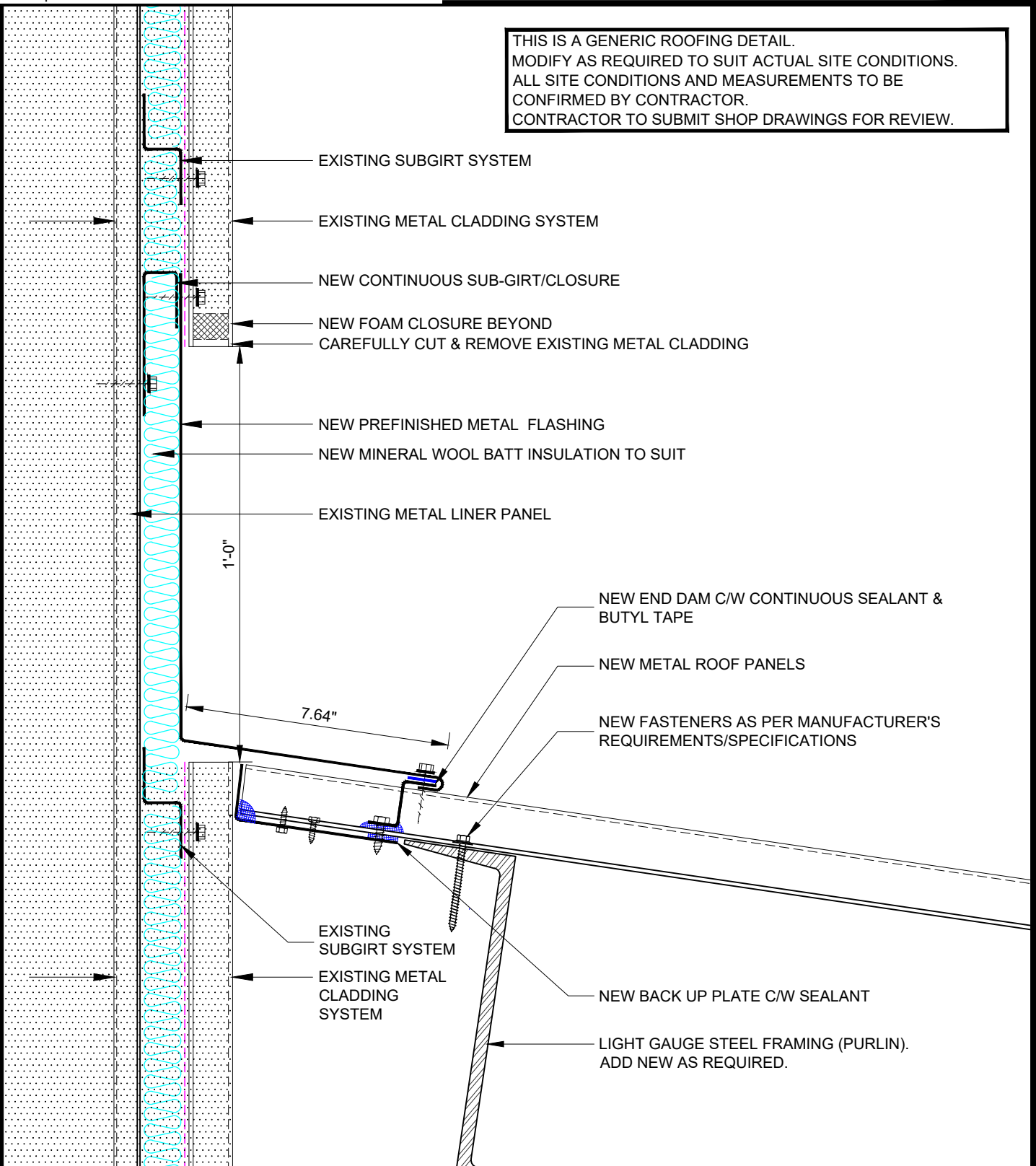

RIMKUS
 1900 S. HARBOR CITY BLVD, SUITE 228
 MELBOURNE, FL 32901
 EXPERT@RIMKUS.COM
 (866) 229-0302

SEAL:

CRAIG A. WILLIAMS
 LICENSE
 No 81819
 STATE OF FLORIDA
 PROFESSIONAL ENGINEER
 4/28/23

PROJECT: METAL ROOF REPLACEMENT (ASSET NO. 259-001)
 18000 PAULSON DR. PORT CHARLOTTE, FL
 CLIENT: FLORIDA LEAGUE OF CITIES
 SHEET TITLE: HIGHWALL FLASHING DETAIL (CANOPY ROOFS)

FOR CLIENT'S SOLE USE PER GOVERNING CONTRACT AND LIMITED TO APPLICABLE PROJECT. NO MODIFICATIONS OR REPRODUCTIONS WITHOUT WRITTEN APPROVAL OF RIMKUS. CONTRACTOR SOLELY RESPONSIBLE FOR VERIFYING ALL DIMENSIONS.

NO.	ISSUED FOR:	DATE (Y-M-D):
1.	ISSUED FOR REVIEW	2023-04-20
2.	REVISION #1	2023-04-24
3.	ISSUED FOR PERMITTING	2023-04-28
4.		
5.		
6.		
7.		

PROJECT NO.: 100189039
 DESIGNED BY: D.G.F.S.
 DRAWN BY: A.A.S.
 CHECKED BY: M.H./M.P.
 SCALE: 3" = 1'-0"

DATE (Y-M-D): 2023-04-17
 DRAWING NO.:
D6
 SHEET NO.: 9 OF 9

GLN040